

Habana Ave.

Caminiti Exceptional Center

Box 0822 Station 10

Caminiti Exceptional Center
2600 W. Humphrey St.
Tampa, FL 33614

Arrawana Ave.

Oren Ave.

To Armenia Ave.

To Waters Ave.

Parking Lot

Bus Ramp

Pre-Fire Plan

Court Yard

Do not use this area
for evacuation

Court Yard

NOTES:

-Use school board keys for access to locked areas

-Single Story, Sprinkled Building

-Approx. 200 special needs students

-Most needy students located in NW wing. Wheelchair bound.

-School contact: Juan Guevara 813-975-7611

-Blue Top Hydrant

O'Rourke & Iglesias 02/2012

Main Electrical Room
Generator and Shutoff

Main Gas Shutoff

A/C

Sprinkler Shutoff Valve

Cafeteria
Lunch Room

Teacher's
Lounge

Stage

Storage

Storage

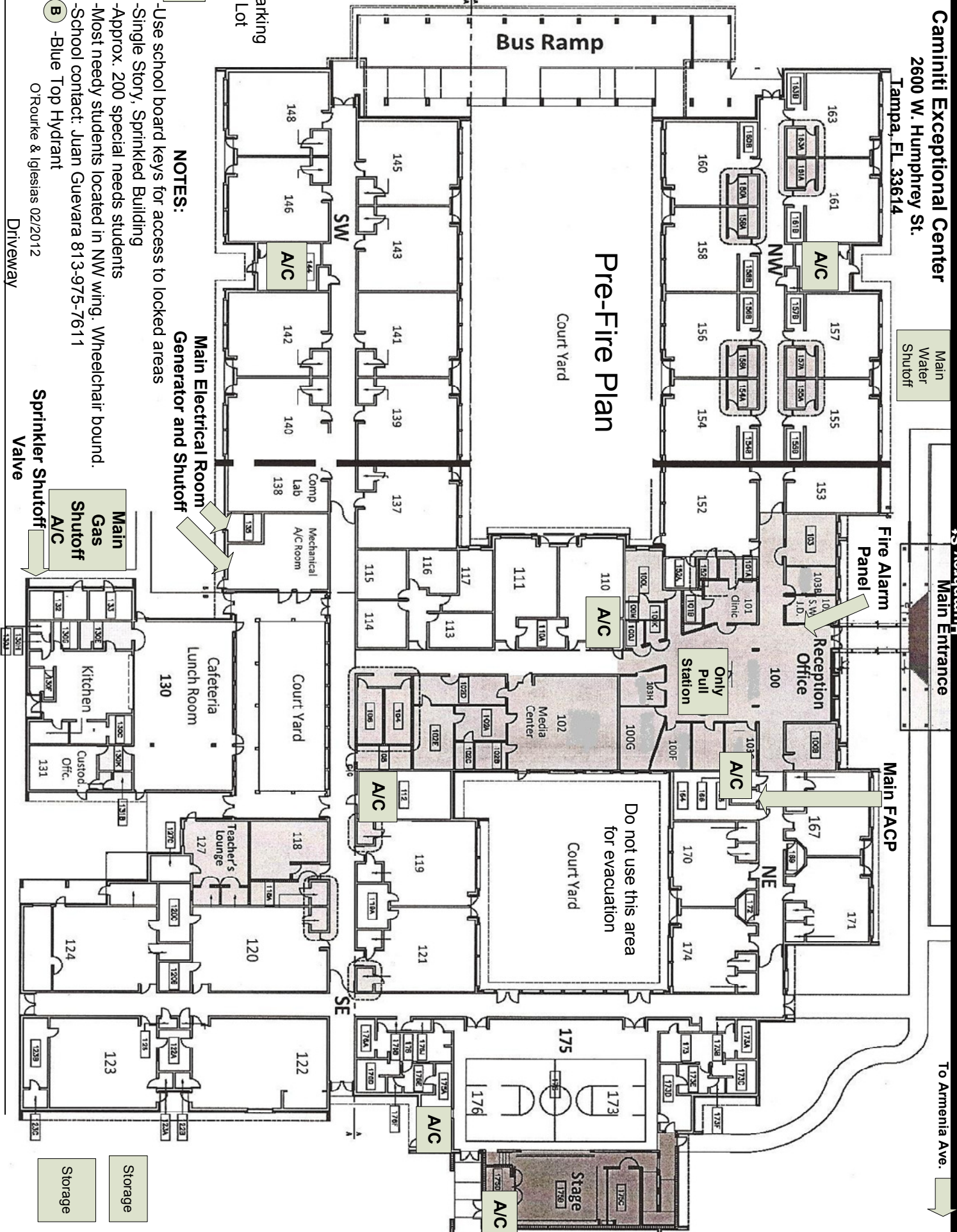

FDC

B

B

B